



### FEATURES

- NXP i.MX8M Mini Application Processor
- Standard 802.3af POE Gigabit Ethernet Port
- Android 9, 10, Yocto Embedded Linux, & Debian Linux
- Built-in 5MP MIPI Camera & Dual Digital Microphones
- Smart Codec With Dual-core DSP, Alexa Voice Service
- On-board WiFi/BT, Proximity, Ambient Light Sensor & GPIO Ports
- PCIe Expansion, Google's Edge TPU For High-Performance ML

The PPC-4607 is a slim table-like all-in-one Panel PC with touch screen. The system equips with NXP's i.MX8M Mini Quad Core ARM processor with a guaranteed 10-year lifespan. In-wall mounting design allows the panel to be mounted on standard 2-gang electrical box. Alexa voice control, Google Edge TPU for ML ready and the gigabit Ethernet PoE (Power over Ethernet) option makes it perfect for home automation, building automation, HMI, control panel and interactive IoT applications.

### SPECIFICATIONS

#### SYSTEM

Processor	NXP i.MX 8MQuad, 4x ARM Cortex-A53 @ 1.8GHz
Platform	ARM Cortex-A53
Memory	2GB Onboard LPDDR4
OS	Android 9, Android 10, Yocto Embedded Linux, Debian Linux
Storage	Onboard iNAND flash (16GB default) 1x micro SD slot 265K EEPROM with Write Protect Control
Security	NXP High Assurance Boot (HAB) secure boot, TEE, Trusty OS and Android Verified Boot (AVB) on Android 10, write protect on-board EEPROM

#### DISPLAY

Interface	LVDS
Display Type	TFT Active Matrix LED Backlight
Screen Size	7"
Resolution	1024 x 600
Luminance	350 cd/m2
View Angle	85°
Contrast Ratio	800:1
Backlight Lifetime	30,000 Hr (Typical)
Touch Screen	Projected Capacitive Touch Screen
Touch Controller	I <sup>2</sup> C

#### COMMUNICATIONS

Ethernet	1x 10/100/1000 Mbps GbE with POE option (via add-on card)
Wi-Fi	802.11 ac/a/b/g/n
Bluetooth	Bluetooth v4.2

#### I/O INTERFACE

Sensors	Proximity Ambient Light
Audio	1x Mono Speaker (1.5W) 2x Digital MICs
Camera	5MP, MIPI interface
Ports	1x RS-232/RS-485 via Terminal Block 4x Optical Isolated GPIOs via Terminal Block 1x USB 2.0 Type A 1x USB Type C 3.0 OTG/Host
Voice Control	Dual-core hardware DSP, omni-directional spatial, noise suppression, and acoustic echo cancellation (AEC), Alexa Voice Service and Wake Word Engine

#### EXPANSION I/O

Expansion Modules (Option)	4G WLAN Google TPU Zigbee
----------------------------	---------------------------------

#### MECHANICAL

Cooling	Fanless
Enclosure Material	Plastic and Metal
Enclosure Color	Black White
Mounting	100 x 100 mm VESA Mount In-wall Mount for 2-Gang Box
Dimensions	219mm x 153mm x 38mm

#### POWER

AC Adapter	POE, 12V DC or 24V AC Input (via Optional IO Module)
------------	--

#### ENVIRONMENTAL

Protection	Front Panel IP65 2mm Tempered Glass
Operating Temp	0°C to 50°C (32°F to 122°F)
Storage Temp	-20°C to 70°C (-4°F to 158°F)
Humidity	10% to 95% Non-condensing

\*Specifications are representative. Specific product technology may be different than indicated.

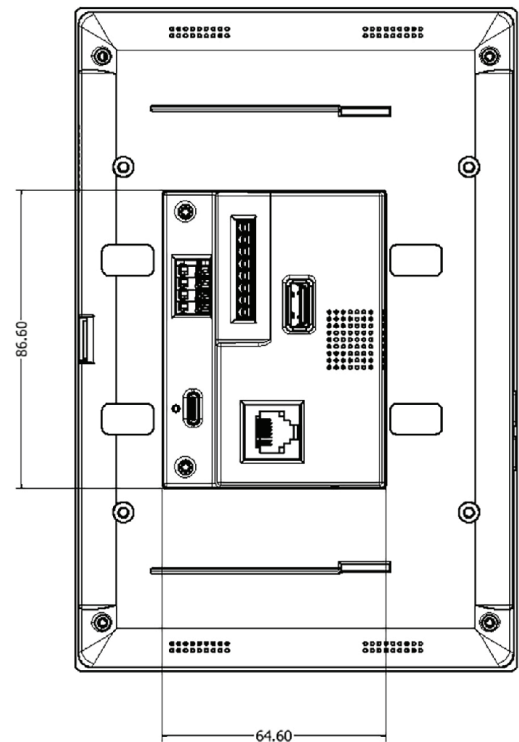
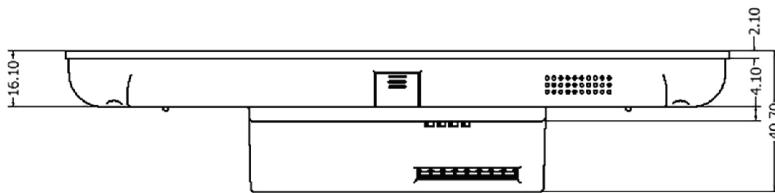
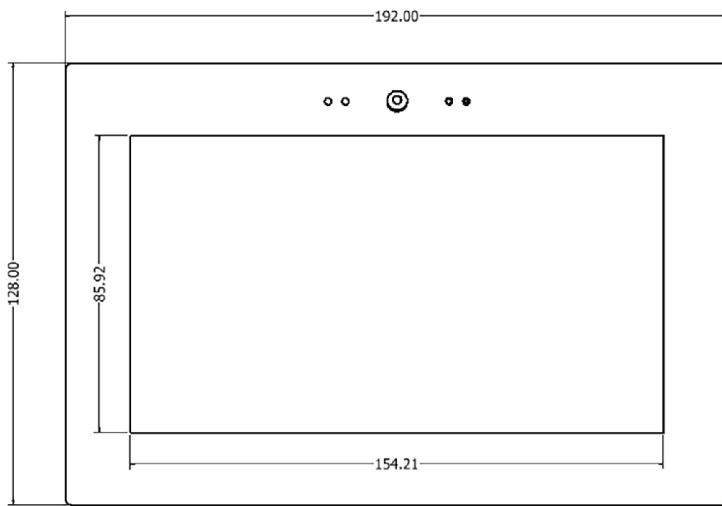
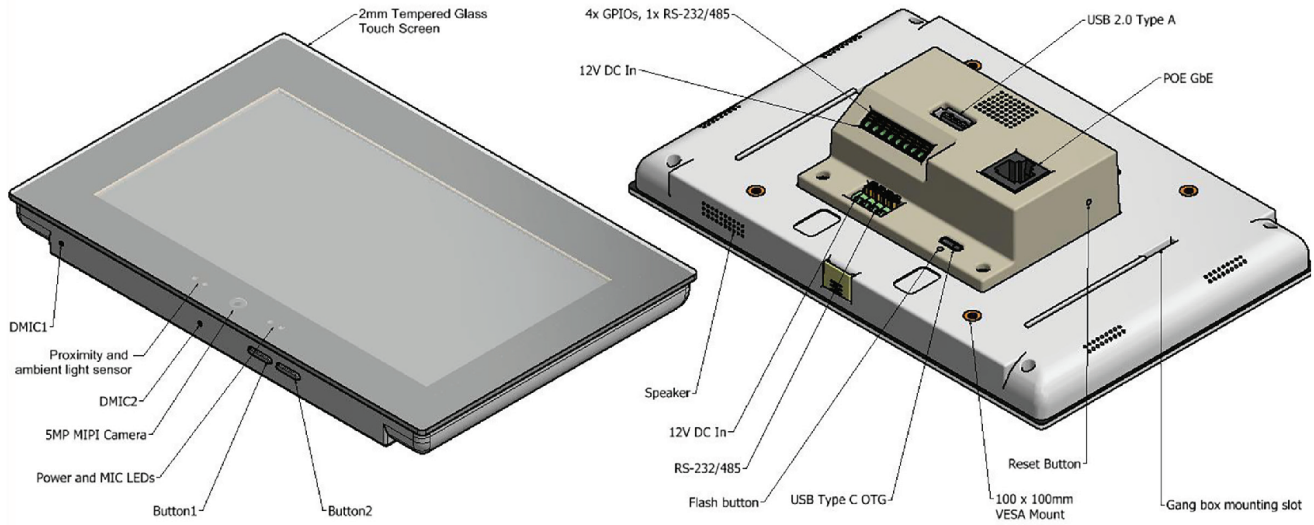

### ORDER OPTIONS

PART NUMBER	DESCRIPTION
PPC-4607-SL	7" Panel PC, i.MX8M Mini, 2G RAM, 15G eMMC, 12V DC In, USB Type C, 1x RS-232/485, 100 x 100mm VESA Mounting
PPC-4607-POE	7" Panel PC, i.MX8M Mini, 2G RAM, 15G eMMC, POE Add-on Board With POE GbE, 4x GPIOs, 1x RS-232/485, 1x USB 2.0
POE-4607-TMO	7" Panel PC, i.MX8M Mini, 2G RAM, 15G eMMC, Thermostat Add-on Board With 4x GPIO Relays, 24V AC In, 1x USB 2.0
POE-4607-STD	7" Panel PC, i.MX8M Mini, 2G RAM, 15G eMMC, IO Add-on Board With 1x GbE, 4x GPIOs, 2x RS-232/485, 9V-24V DC In, 2x USB 2.0